

ORNAMENTAL GATE HARDWARE | GATE END GUIDE

	1.25"sq x 16ga	1.75"sq x 14ga	2"sq x 11ga	
STEEL	Montage Gates	●		
	Montage Arched Gates	●		
	Montage Plus Gates		●	
	Montage Plus Arched Gates		●	
	Montage Plus Estate Gates			●
	Montage Commercial Gates		●	
	Montage Commercial Arched Gates		●	
	Montage Commercial Estate Gates			●
	Montage II Gates			●
	Montage II Arched Gates			●
	Montage II Estate Gates			●
	Aegis Gates	●		
	Aegis Plus Gates		●	
	Aegis II Gates			●
	Impasse II Gates			●

	1.25"sq x .125" wall	1.75"sq x .125" wall	2"sq x .250" wall	
ALUMINUM	Aegis Plus Arched Gates		●	
	Echelon Gates	●		
	Echelon Arched Gates	●		
	Echelon Plus Gates		●	
	Echelon Plus Arched Gates			●
	Echelon II Gates			●
	Estate Gates			●

Effective: 01/01/15

ORNAMENTAL GATE HARDWARE | SINGLE & DOUBLE SWING KITS

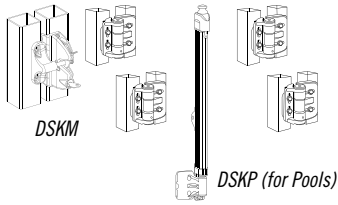

DESCRIPTION	HC	LC	ITEM NUMBER	BOX QTY	BOX WEIGHT
D&D Single Gate Hardware Kits	1.125"	.75"	DSKM*	1	2 lbs
	1.125"	.75"	DSKP**	1	3 lbs

*DSKM Kit includes: (1) pr. #TCAMA1 | (1) ea. #LLAAB
 **DSKP Kit (for pools) includes: (1) pr. #TCAMA1 | (1) ea. #MLTPS2BGA
 Kits for use with: Montage Gates | Montage Arched Gates | Echelon Gates | Echelon Arched Gates
 These kits are **NOT FOR USE** with gate leaves weighing over 62 lbs. | Available in BLACK only

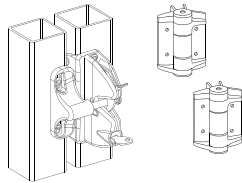

D&D Heavy Duty Single Gate Hardware Kit	.75"	.75"	TCPGK	1	3 lbs
---	------	------	-------	---	-------

TCPGK Kit includes: (1) pr. #8000-2115 | (1) ea. #LLDAB-KSA
 Kits for use with: Montage Gates | Montage Arched Gates | Echelon Gates | Echelon Arched Gates
 These kits are **NOT FOR USE** with gate leaves weighing over 132 lbs. | Available in BLACK only

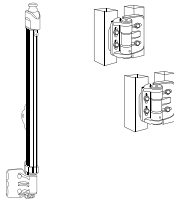

D&D Heavy Duty Single Gate Pool Safety Hardware Kit	.75"	.75"	TCSGK	1	3 lbs
---	------	------	-------	---	-------

TCSGK Kit (for pools) includes: (1) pr. #8000-2115 | (1) ea. #MLTPS2BGA
 Kits for use with: Montage Gates | Montage Arched Gates | Echelon Gates | Echelon Arched Gates
 These kits are **NOT FOR USE** with gate leaves weighing over 132 lbs. | Available in BLACK only

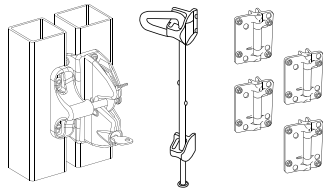

D&D Double Gate Hardware Kit	.75"	.75"	DDKM	1	5 lbs
------------------------------	------	------	------	---	-------

DDKM Kit includes: (2) pr. #8000-2081 | (1) ea. #LLAAB | (1) ea. #QB124
 Kits for use with: Montage Gates | Montage Arched Gates | Echelon Gates | Echelon Arched Gates
 These kits are **NOT FOR USE** with gate leaves weighing over 62 lbs. | Available in BLACK only

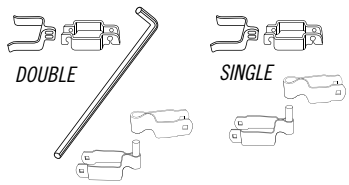

Bolt-On Hinge Kits for 1.25" Uprights with Fork Latch	2"	2"	SG@S2*	1	4 lbs
	2"	2"	SG@D2**	1	13 lbs

*SGBS2 Kit (for single swing gates) includes: (1) pr. #HB404 | (1) pr. #HB403 | (1) ea. #HB301 | (1) ea. #HB402
 **SGBD2 Kit (for double swing gates) includes: (3) pr. #HB404 | (2) pr. #HB403 | (1) pr. #HB301 | (1) ea. #HB401 | (1) ea. #HB316
 Kits for use with: Montage Gates | Montage Arched Gates | Aegis Gates | Echelon Gates | Echelon Arched Gates
 These kits are **NOT FOR USE** with gate leaves weighing over 90 lbs.

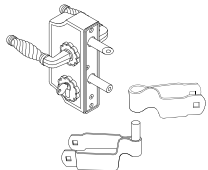

Bolt-On Hinge Kit for 1.25" Uprights with Ameristar Lock	2"	.625"	SG@S2A	1	2 lbs
--	----	-------	--------	---	-------

Ameristar Lock / Bolt on Hinge Kit includes: (1) pr. #HB404 | (1) pr. #HB403 | (1) pr. #HB504S
 Kits for use with: Montage Gates | Aegis Gates | Echelon Gates | Echelon Arched Gates | Aegis Gates
 These kits are **NOT FOR USE** with gate leaves weighing over 90 lbs.

Effective: 01/06/15

ORNAMENTAL GATE HARDWARE | SINGLE & DOUBLE SWING KITS

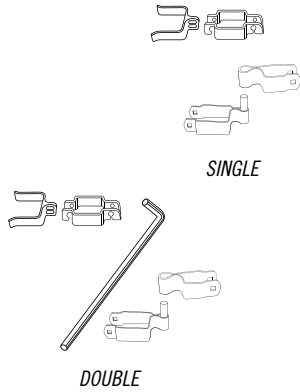

DESCRIPTION	SIZE	HC	LC	ITEM NUMBER	BOX QTY	BOX WEIGHT
Bolt-On Hinge Kits for 1.75\" Uprights with Fork Latch	1.75\" x 2.5\"	2\"	2\"	AG⊗S25*	1	5 lbs
	1.75\" x 3\"	2\"	2\"	SG⊗S3**	1	6 lbs
	1.75\" x 2.5\"	2\"	2\"	AG⊗D***	1	15 lbs
	1.75\" x 3\"	2\"	2\"	SG⊗D3****	1	16 lbs

*AG⊗S25 Kit (for single swing gates) includes: (1) pr. #HB413 | (1) pr. #HB414 | (1) ea. #HB411 | (1) ea. #HB311

**SG⊗S3 Kit (for single swing gates) includes: (1) pr. #HB415 | (1) pr. #HB414 | (1) ea. #HB311 | (1) ea. #HB412

***AG⊗D Kit (for double swing gates) includes: (2) pr. #HB413 | (3) pr. #HB414 | (1) ea. #HB410 | (1) ea. #HB311 | (1) ea. #HB316

****SG⊗D3 Kit (for double swing gates) includes: (2) pr. #HB415 | (3) pr. #HB414 | (1) ea. #HB410 | (1) ea. #HB311 | (1) ea. #HB316

Kits for use with: Montage Plus Gates | Aegis Plus Gates | Echelon Plus Gates

These kits are **NOT FOR USE** with gate leaves weighing over 90 lbs.

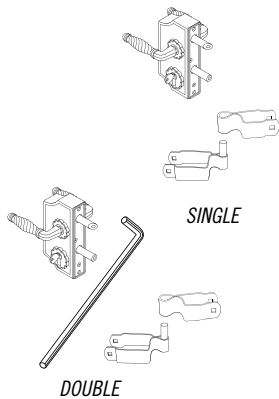

Bolt-On Hinge Kits for 1.75\" Uprights with Ameristar Lock	1.75\" x 2.5\"	2\"	.625\"	SG⊗S25A*	1	9 lbs
	1.75\" x 3\"	2\"	.625\"	SG⊗S3A**	1	10 lbs
	1.75\" x 2.5\"	2\"	.625\"	SG⊗D25A*	1	19 lbs

*SGBS25A Kit (for single swing gates) includes: (1) pr. #HB413 | (1) pr. #HB414 | (1) ea. #HB509S

**SGBS3A Kit (for single swing gates) includes: (1) pr. #HB413 | (1) pr. #HB414 | (1) ea. #HB509S

***SGBD25A Kit (for double swing gates) includes: (2) pr. #HB413 | (3) pr. #HB414 | (1) ea. #HB316 | (1) ea. #HB509S

Kits for use with: Montage Plus Gates | Aegis Plus Gates

These kits are **NOT FOR USE** with gate leaves weighing over 90 lbs.

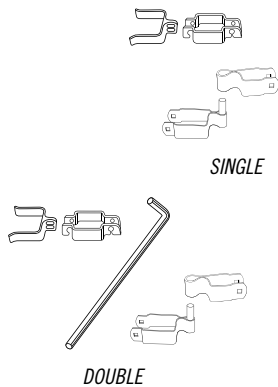

Bolt-On Hinge Kits for 2\" Uprights with Fork Latch	2\" x 2.5\"	2\"	2\"	EG⊗S25*	1	5 lbs
	2\" x 3\"	2\"	2\"	EG⊗S3**	1	6 lbs
	2\" x 2.5\"	2\"	2\"	EG⊗D***	1	15 lbs
	2\" x 3\"	2\"	2\"	EG⊗D3****	1	15 lbs

*EG⊗S25 Kit (for single swing gates) includes: (1) pr. #HB413 | (1) pr. #HB416 | (1) ea. #HB420 | (1) ea. #HB411

**EG⊗S3 Kit (for single swing gates) includes: (1) pr. #HB415 | (1) pr. #HB416 | (1) ea. #HB420 | (1) ea. #HB412

***EG⊗D Kit (for double swing gates) includes: (2) pr. #HB413 | (3) pr. #HB416 | (1) ea. #HB420 | (1) ea. #HB402 | (1) ea. #HB316

****EG⊗D3 Kit (for double swing gates) includes: (2) pr. #HB415 | (3) pr. #HB416 | (1) ea. #HB420 | (1) ea. #HB402 | (1) ea. #HB316

Kits for use with: Estate Gates | Aegis Plus Arched Gates | Echelon Plus Arched Gates

These kits are **NOT FOR USE** with gate leaves weighing over 90 lbs.

⊗ = COLOR OPTIONS AVAILABLE | B = Black N = Bronze S = Sand

HC = hinge clearance | LC = latch clearance

Effective: 01/06/15

ORNAMENTAL GATE HARDWARE | SINGLE & DOUBLE SWING KITS

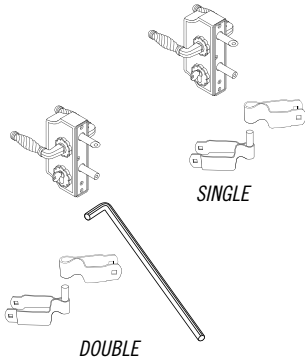

DESCRIPTION	SIZE	HC	LC	ITEM NUMBER	BOX QTY	BOX WEIGHT
Bolt-On Hinge Kits for 2" Uprights with Ameristar Lock	2" x 2.5"	2"	.625"	EG⊗S25A*	1	9 lbs
	2" x 3"	2"	.625"	EG⊗S3A**	1	10 lbs
	2" x 2.5"	2"	.625"	EG⊗DA***	1	19 lbs

*EG⊗S25A Kit (for single swing gates) includes: (1) pr. #HB413 | (1) pr. #HB416 | (1) ea. #HB509S

**EG⊗S3A Kit (for single swing gates) includes: (1) pr. #HB415 | (1) pr. #HB416 | (1) ea. #HB509S

***EG⊗DA Kit (for double swing gates) includes: (2) pr. #HB413 | (3) pr. #HB416 | (1) ea. #HB316 | (1) ea. #HB509S

Kits for use with: Estate Gates | Aegis Plus Arched Gates | Echelon Plus Arched Gates

These kits are **NOT FOR USE** with gate leaves weighing over 90 lbs.

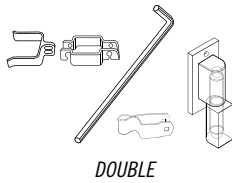

Box Hinge Kit for 1.75" Aluminum Uprights & Steel Posts with Fork Latch	1.75"	2.375"	2"	AG⊗DX	1	22 lbs
---	-------	--------	----	-------	---	--------

AG⊗DX Kit (for double swing gates) includes: (2) pr. #HB518 | (1) ea. #HB311 | (1) ea. #HB410 | (1) ea. #HB414 | (1) ea. #HB316

Kit for use with: Echelon Plus Gates

These kits are **NOT FOR USE** with gate leaves weighing under 90 lbs.

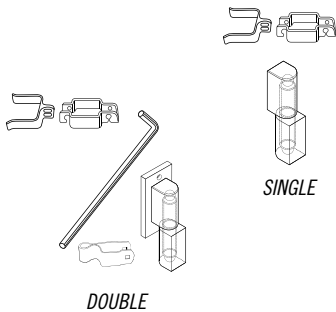

Box Hinge Kits for 1.75" Steel Uprights & Posts with Fork Latch	1.75" x 2.5"	2"	2"	SG⊗SX25*	1	9 lbs
	1.75" x 3"	2"	2"	SG⊗SX3**	1	9 lbs
	1.75" x 2.5"	2"	2"	SG⊗DX***	1	23 lbs

*SG⊗X25 Kit (for single swing gates) includes: (1) pr. #HU517 | (1) ea. #HB411 | (1) ea. #HB311

**SG⊗SX3 Kit (for single swing gates) includes: (1) pr. #HU517 | (1) ea. #HB412 | (1) ea. #HB311

***SG⊗DX Kit (for double swing gates) includes: (2) pr. #HU517 | (1) pr. #HB414 | (1) ea. #HB410 | (1) ea. #HB311 | (1) ea. #HB316

Kits for use with: Montage Plus Gates | Aegis Plus Gates

These kits are **NOT FOR USE** with gate leaves weighing under 90 lbs.

⊗ = COLOR OPTIONS AVAILABLE | B = Black N = Bronze S = Sand

HC = hinge clearance | LC = latch clearance

Effective: 01/06/15

ORNAMENTAL GATE HARDWARE | SINGLE & DOUBLE SWING KITS

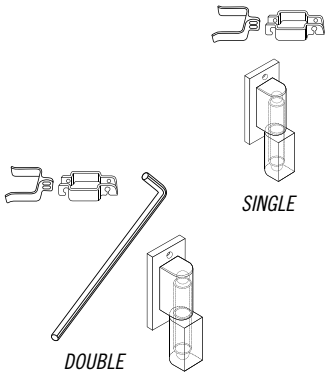

DESCRIPTION	SIZE	HC	LC	ITEM NUMBER	BOX QTY	BOX WEIGHT
Box Hinge Kit for 2" Aluminum Upright & Steel Post with Fork Latch	2" x 2.5"	2.375"	2"	EG⊗SX25*	1	9 lbs
	2" x 3"	2.375"	2"	EG⊗SX3**	1	9 lbs
	2" x 2.5"	2.375"	2"	EG⊗DX***	1	23 lbs

*EG⊗SX25 Kit (for single swing gates) includes: (1) pr. #HU518 | (1) ea. #HB411 | (1) ea. #HB420

**EG⊗SX3 Kit (for single swing gates) includes: (1) pr. #HU518 | (1) ea. #HB412 | (1) ea. #HB420

***EG⊗DX Kit (for double swing gates) includes: (2) pr. #HU518 | (1) pr. #HB416 | (1) ea. #HB316 | (1) ea. #HB420 | (1)ea. #HB402

Kits for use with: Estate Gates | Aegis Plus Arched Gates | Echelon Plus Arched Gates | Echelon II Gates

These kits are **NOT FOR USE** with gate leaves weighing under 90 lbs.

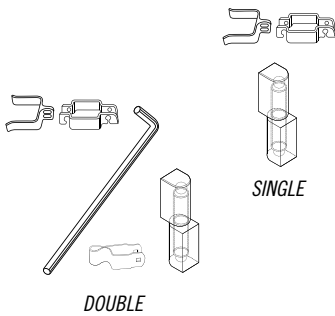

Box Hinge Kit for 2" Steel Upright & Steel Post with Fork Latch	2" x 2.5"	2"	2"	IG⊗SX25*	1	9 lbs
	2" x 3"	2"	2"	IG⊗SX3**	1	9 lbs
	2" x 2.5"	2"	2"	IG⊗DX***	1	23 lbs

*IG⊗SX25 Kit (for single swing gates) includes: (1) pr. #HU517 | (1) ea. #HB411 | (1) ea. #HB420

**IG⊗SX3 Kit (for single swing gates) includes: (1) pr. #HU517 | (1) ea. #HB412 | (1) ea. #HB420

***IG⊗DX Kit (for double swing gates) includes: (2) pr. #HU517 | (1) pr. #HB416 | (1) ea. #HB402 | (1) ea. #HB420 | (1)ea. #HB402

Kits for use with: Aegis II Gates | Montage II Gates | Impasse II Gates

These kits are **NOT FOR USE** with gate leaves weighing under 90 lbs.

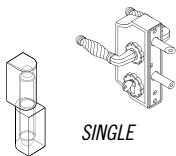

Box Hinge Kit for Steel Uprights & Posts with Ameristar Lock	n/a	2"	.625"	SG⊗SXA	1	12 lbs
--	-----	----	-------	--------	---	--------

SG⊗SXA Kit (for single swing gates) includes: (1) pr. #HU517 | (1) ea. #HB509S

Kit for use with: Montage Plus Gates | Aegis Plus Gates | Montage II Gates | Aegis II Gates | Impasse II Gates

These kits are **NOT FOR USE** with gate leaves weighing under 90 lbs.

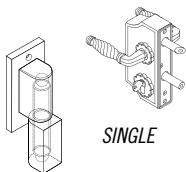

Box Hinge Kit for Aluminum Uprights & Steel Posts with Ameristar Lock	n/a	2.375"	.625"	EG⊗SXA	1	12 lbs
---	-----	--------	-------	--------	---	--------

EG⊗SXA Kit (for single swing gates) includes: (1) pr. #HU518 | (1) ea. #HB509S

Kit for use with: Echelon Plus Gates | Estate Gates | Echelon Plus Arched Gates | Aegis Plus Arched Gates | Echelon II Gates

These kits are **NOT FOR USE** with gate leaves weighing under 90 lbs.

ORNAMENTAL GATE HARDWARE | SINGLE & DOUBLE SWING KITS

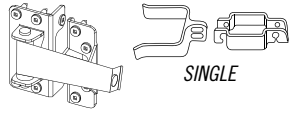

SINGLE

DESCRIPTION	SIZE	HC	LC	ITEM NUMBER	BOX QTY	BOX WEIGHT
Residential Hinge Kit for .25" Uprights with Fork Latch	1.25" x 2"	1"	2"	RG⊗S*	1	10 lbs
	1.25" x 2"	1"	2"	RG⊗D**	1	17 lbs

*RG⊗S Kit (for single swing gates) includes: (1) pr. #MRH180R | (1) ea. #HB402 | (1) ea. #HB301

**RG⊗D Kit (for double swing gates) includes: (2) pr. #MRH180R | (1) ea. #HB401 | (1) ea. #HB301 | (1) pr. #HB404 | (1) ea. #HB316

Kits for use with: Montage Gates | Aegis Gates | Echelon Gates

These kits are **NOT FOR USE** with gate leaves weighing over 120 lbs.

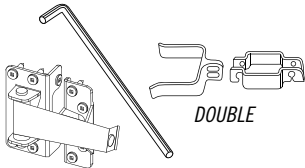

DOUBLE

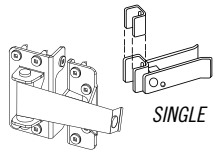

SINGLE

Commercial Hinge Kit for 1.75" & 2" Uprights & 2.5" Posts with Strong Arm Gate Latch	2.5"	1"	3"	CG⊗S-25*	1	12 lbs
	2.5"	1"	2"	CG⊗D**	1	19 lbs

*CG⊗S-25 Kit (for single swing gates) includes: (1) pr. #MCHI80R | (1) ea. #DSB250

**CG⊗D Kit (for double swing gates) includes: (2) pr. #MCHI80R | (1) ea. #DSB200

Kits for use with: Montage Plus Gates | Aegis Plus Gates | Echelon Plus Gates

These kits are **NOT FOR USE** with gate leaves weighing over 240 lbs.

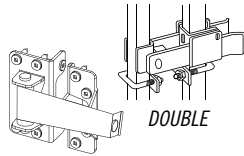

DOUBLE

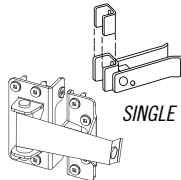

SINGLE

Commercial Hinge Kit for 1.75" & 2" Uprights & 3" Post with Strong Arm Gate Latch	3"	1"	3"	CG⊗S-3	1	15 lbs
---	----	----	----	--------	---	--------

CG⊗SA Kit (for single swing gates) includes: (1) pr. #MCHI80R | (1) ea. #DSB300

Kit for use with: Montage Plus Gates | Aegis Plus Gates | Echelon Plus Gates

These kits are **NOT FOR USE** with gate leaves weighing over 240 lbs.

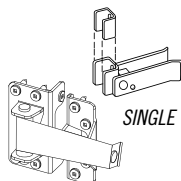

SINGLE

Commercial Hinge Kit for 1.75" & 2" Uprights & 4" Post with Strong Arm Gate Latch	4"	1"	3"	CG⊗S-4	1	17 lbs
---	----	----	----	--------	---	--------

CG⊗SA Kit (for single swing gates) includes: (1) pr. #MCHI80R | (1) ea. #DSB100

Kit for use with: Montage Plus Gates | Aegis Plus Gates | Echelon Plus Gates

These kits are **NOT FOR USE** with gate leaves weighing over 240 lbs.

⊗ = **COLOR OPTIONS AVAILABLE** | **B** = Black | **N** = Bronze | **S** = Sand | Hinges are available in BLACK only

HC = hinge clearance | LC = latch clearance

Effective: 01/06/15

ORNAMENTAL GATE HARDWARE | SINGLE & DOUBLE SWING KITS

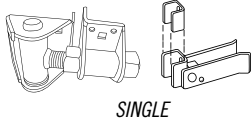

SINGLE

DESCRIPTION	SIZE	HC	LC	ITEM NUMBER	BOX QTY	BOX WEIGHT
Heavy Commercial Hinge Kit for 1.75" & 2" Uprights & 2.5" Posts with Strong Arm Gate Latch	2.5"	1.25"	3"	HGⓧS-25*	1	13 lbs
	2.5"	1.25"	2"	HGⓧD**	1	20 lbs

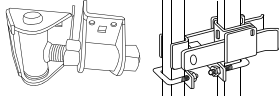

DOUBLE

*HGⓧS-25 Kit (for single swing gates) includes: (1) pr. #MHH180 | (1) ea. #DSB250

**HGⓧD Kit (for double swing gates) includes: (2) pr. #MHH180 | (1) ea. #DSB200

Kits for use with: Montage Plus Gates | Montage II Gates | Aegis Plus Gates | Aegis II Gates | Echelon Plus Gates | Echelon II Gates | Echelon Plus Arched Gates | Aegis Plus Arched Gates | Estate Gates

These kits are **NOT FOR USE** with gate leaves weighing over 420 lbs.

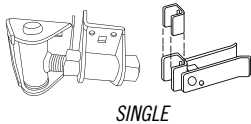

SINGLE

Heavy Commercial Hinge Kit for 1.75" & 2" Uprights & 3" Post with Strong Arm Gate Latch	3"	1.25"	3"	HGⓧS-3	1	15 lbs
---	----	-------	----	--------	---	--------

HGⓧS-3 Kit (for single swing gates) includes: (1) pr. #MHH180 | (1) ea. #DSB300

Kit for use with: Montage Plus Gates | Aegis Plus Gates | Echelon Plus Gates | Montage II Gates | Aegis II Gates | Echelon II Gates | Aegis Plus Arched Gates | Echelon Plus Arched Gates | Estate Gates

These kits are **NOT FOR USE** with gate leaves weighing over 420 lbs.

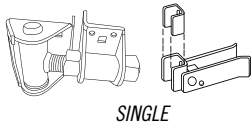

SINGLE

Heavy Commercial Hinge Kit for 1.75" & 2" Uprights & 4" Post with Strong Arm Gate Latch	4"	1.25"	3"	HGⓧS-4	1	17 lbs
---	----	-------	----	--------	---	--------

HGⓧS-44 Kit (for single swing gates) includes: (1) pr. #MHH180 | (1) ea. #DSB100

Kit for use with: Montage Plus Gates | Aegis Plus Gates | Echelon Plus Gates | Montage II Gates | Aegis II Gates | Echelon II Gates | Aegis Plus Arched Gates | Echelon Plus Arched Gates | Estate Gates

These kits are **NOT FOR USE** with gate leaves weighing over 420 lbs.

ⓧ = **COLOR OPTIONS AVAILABLE** | **B** = Black | **N** = Bronze | **S** = Sand | Hinges are available in BLACK only

HC = hinge clearance | LC = latch clearance

ORNAMENTAL GATE HARDWARE | SINGLE & DOUBLE SWING KITS

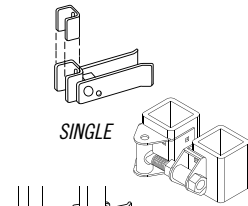

SINGLE

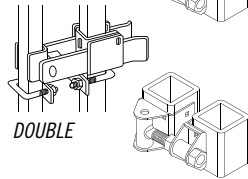

DOUBLE

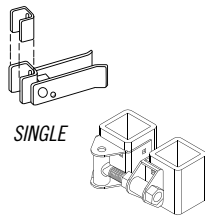

SINGLE

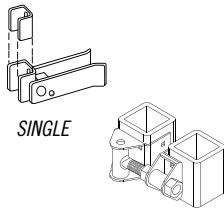

SINGLE

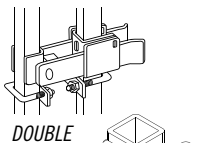

DOUBLE

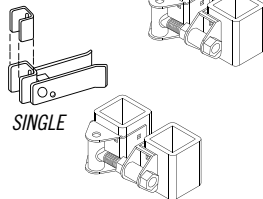

SINGLE

DESCRIPTION	SIZE	HC	LC	ITEM NUMBER	BOX QTY	BOX WEIGHT
Industrial Hinge Kits for 1.75" & 2" Uprights & 2.5" Posts with Strong Arm Latch	2.5"	1.5"	3"	IG⊗S-25*	1	20 lbs
	2.5"	1.5"	2"	IG⊗D**	1	25 lbs

*IG⊗S-25 Kit (for single swing gates) includes: (1) pr. #MIH180 | (1) ea. #DSB250

**IG⊗D Kit (for double swing gates) includes: (2) pr. #MIH180 | (1) ea. #DSB200

Kits for use with: Montage II Gates | Aegis II Gates | Echelon II Gates | Impasse II Gates

These kits are **NOT FOR USE** with gate leaves weighing over 3,000 lbs.

Industrial Hinge Kit for 1.75" & 2" Uprights & 3" Posts with Strong Arm Latch	3"	1.5"	3"	IG⊗S-3	1	22 lbs
---	----	------	----	--------	---	--------

IG⊗S-3 Kit (for single swing gates) includes: (1) pr. #MIH180 | (1) ea. #DSB300

Kits for use with: Montage II Gates | Aegis II Gates | Echelon II Gates | Impasse II Gates

These kits are **NOT FOR USE** with gate leaves weighing over 3,000 lbs.

Industrial Hinge Kit for 1.75" & 2" Uprights & 4" Posts with Strong Arm Latch	3"	1.5"	3"	IG⊗S-4	1	24 lbs
---	----	------	----	--------	---	--------

IG⊗S-4 Kit (for single swing gates) includes: (1) pr. #MIH180 | (1) ea. #DSB100

Kits for use with: Montage II Gates | Aegis II Gates | Echelon II Gates | Impasse II Gates

These kits are **NOT FOR USE** with gate leaves weighing over 3,000 lbs.

Industrial Hinge Kit for 1.75" & 2" Uprights & 2.5" Posts with Strong Arm Latch	3"	1.5"	3"	IGBS⊗25	1	22 lbs
	2"	1.5"	2"	IGBD	1	25 lbs

*IG⊗S-25 Kit (for single swing gates) includes: (1) pr. #MIH180 | (1) ea. #DSB250

**IGBD Kit (for double swing gates) includes: (1) pr. #MIH180 | (1) ea. #DSB200

Kits for use with: Montage II Gates | Aegis II Gates | Echelon II Gates | Impasse II Gates

These kits are **NOT FOR USE** with gate leaves weighing over 3,000 lbs.

⊗ = **COLOR OPTIONS AVAILABLE** | **B** = Black | **N** = Bronze | **S** = Sand | Hinges are available in BLACK only

HC = hinge clearance | LC = latch clearance

Effective: 01/06/15

ORNAMENTAL GATE HARDWARE | SINGLE & DOUBLE SWING KITS

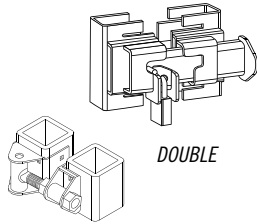

DOUBLE

DESCRIPTION	SIZE	HC	LC	ITEM NUMBER	BOX QTY	BOX WEIGHT
Industrial Hinge Kit for 2" Uprights & 3" Post with Industrial Double Drive Gate Latch	n/a	.625" - 2.5"	3.5"	IDDSLHK*	1	46 lbs

IDDSLHK Kit (for double swing gates) includes: (2) pr. #MIH180 | (1) ea. #DDB200

Kits for use with: Impasse II Gates

Notes: Recommended for gate leaves over 60" sq. area (height x OTD) and when 6" sq. posts are required.

*These kits are **NOT FOR USE** with gate leaves weighing over 3,000 lbs.*

** Available in BLACK only*

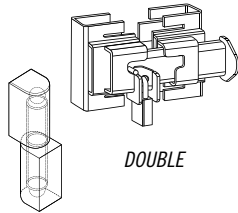

DOUBLE

DESCRIPTION	SIZE	HC	LC	ITEM NUMBER	BOX QTY	BOX WEIGHT
Box Hinge Kit for Welding Steel Uprights & Steel Posts with Industrial Double Drive Gate Latch	n/a	2"	3.5"	SGBDXU**	1	26 lbs

SGBDXU Kit (for double swing gates) includes: (2) pr. #HU517 | (1) ea. #DDB200

Kits for use with: Impasse II Gates

*These kits are **NOT FOR USE** with gate leaves weighing over 3,000 lbs.*

** Hinges available primered only*

⊗ = **COLOR OPTIONS AVAILABLE** | **B** = Black **N** = Bronze **S** = Sand | Hinges are available in BLACK only

HC = hinge clearance | LC = latch clearance

ORNAMENTAL GATE HARDWARE | GATE HINGES

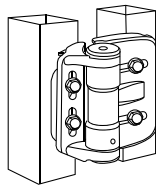

DESCRIPTION	HINGE CLEARANCE	ITEM NUMBER	BOX QTY	BOX WEIGHT
True Close Mini Multi Hinge	1.125"	TCAMA1*	1 pr	2 lbs

For use with: Montage Gates | Montage Arched Gates | Echelon Gates | Echelon Arched Gates

Notes: Self-closing adjustment (vertical, horizontal & tension) | Super-strong engineered polymer & stainless steel construction | Horizontal & vertical adjustment up to .75"

NOT FOR USE with gate leaves weighing over 62 lbs.

* Available in BLACK only

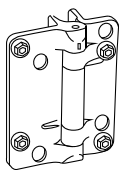

KwikFit Pivoting Hinge	.75"	8000-2081*	1 pr	1 lbs
------------------------	------	------------	------	-------

For use with: Montage Gates | Montage Arched Gates | Echelon Gates | Echelon Arched Gates

Notes: Side-fixing legs provide quick alignment of hinges on gate & fence post | Double face-fixing (fixes to both face & post side of gate) | Super-strong engineered polymer & stainless steel construction | Won't rust, bind, snag or stain

NOT FOR USE with gate leaves weighing over 62 lbs.

* Available in BLACK only

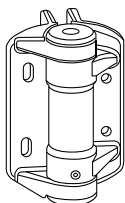

TrueClose Hinge	.75"	8000-2112*	1 pr	1 lbs
-----------------	------	------------	------	-------

For use with: Montage Gates | Montage Arched Gates | Echelon Gates | Echelon Arched Gates

Notes: Self-closing (tension-adjustable) hinge for light to medium weight metal safety gates around pools, homes and gardens | Quick-fit alignment legs for added fitting strength

NOT FOR USE with gate leaves weighing over 66 lbs.

* Available in BLACK only

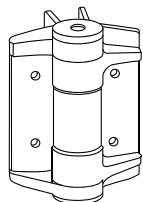

Heavy Duty TruClose Hinge	.75"	8000-2115*	1 pr	1.6 lbs
---------------------------	------	------------	------	---------

For use with: Montage Plus Gates | Montage Plus Arched Gates | Echelon Plus Gates | Echelon Plus Arched Gates

A self-closing (tension-adjustable) hinge for heavier or high-traffic metal gates (especially those with narrow frames) around commercial areas, homes and childcare centers | Quick-fit alignment legs for added fitting strength

NOT FOR USE with gate leaves weighing over 154 lbs.

* Available in BLACK only

Effective: 01/06/15

ORNAMENTAL GATE HARDWARE | GATE HINGES

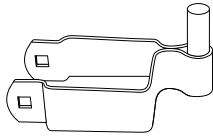

DESCRIPTION	LENGTH	HINGE CLEARANCE	ITEM NUMBER	BOX QTY	WEIGHT EA.
Male Hinge	2"	2"	H⊗403*	100	.46 lbs
	2.5"	2"	H⊗413**	50	.53 lbs
	3"	2"	H⊗415**	50	.57 lbs

*For use with: Montage Gates | Aegis Gates | Echelon Gates | Echelon Arched Gates

**For use with: Montage Plus Gates | Aegis Plus Gates | Echelon Plus Gates | Aegis Plus Arched Gates
Echelon Plus Arched Gates | Estate Gates

Notes: Supplied with stainless steel fasteners | Bolts onto square posts

NOT FOR USE with gate leaves weighing over 90 lbs.

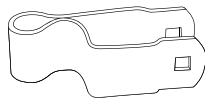

Female Hinge	1.25"	2"	H⊗404*	100	.60 lbs
	1.75"	2"	H⊗414**	100	.66 lbs
	2"	2"	H⊗416***	100	.68 lbs

*For use with: Montage Gates | Aegis Gates | Echelon Gates | Echelon Arched Gates

**For use with: Montage Plus Gates | Aegis Plus Gates | Echelon Plus Gates

***For use with: Aegis Plus Arched Gates | Echelon Plus Arched Gates | Estate Gates

Notes: Supplied with stainless steel fasteners | Bolts onto square uprights

NOT FOR USE with gate leaves weighing over 90 lbs.

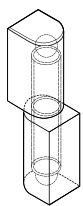

Plate Pintle	.625"	n/a	H⊗108	100	.60 lbs
--------------	-------	-----	-------	-----	---------

*For use with: Montage Gates | Aegis Gates | Echelon Gates | Echelon Arched Gates

Notes: Screws or anchors to walls or other flat surfaces | Mounting fasteners not included

NOT FOR USE with gate leaves weighing over 90 lbs.



FOR STEEL
HU517

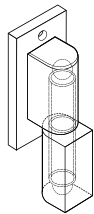

FOR ALUMINUM
HU518

Box Hinges	5"	2"	HU517*	2	4 lbs
	5"	2.375"	HU518**	2	4 lbs

*For use with: Montage Plus Gates | Aegis Plus Gates | Montage II Gates | Aegis II Gates | Impasse II Gates

**For use with: Echelon II Gates | Aegis Plus Arched Gates | Echelon Plus Arched Gates | Estate Gates

Notes: Kits require use of steel posts | Plated side of hinge is for bolting to aluminum gate frame | Non-plated side of hinge is for welding to the steel post | Hinges available primered only

Recommended for gates weighing over 90 lbs.

* Available in PRIMERED ONLY

⊗ = COLOR OPTIONS AVAILABLE | **B** = Black **N** = Bronze **S** = Sand **W** = White

ORNAMENTAL GATE HARDWARE | GATE HINGES

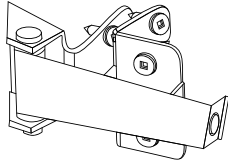

DESCRIPTION	HINGE CLEARANCE	ITEM NUMBER	BOX QTY	BOX WEIGHT
Residential Adjustable 180° Hinge	.5" - 1.625"	MRH180R*	1 pr	2 lbs

For use with: Montage Gates | Aegis Gates | Echelon Gates | Echelon Arched Gates

NOT FOR USE with gate leaves weighing over 120 lbs.

** Available in BLACK only*

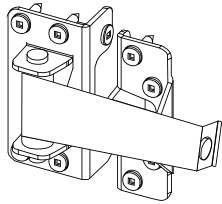

Commercial Adjustable 180° Hinge	.5" - 1.625"	MCH180R*	1 pr	4 lbs
---	--------------	----------	------	-------

For use with: Montage Plus Gates | Aegis Plus Gates | Echelon Plus Gates

NOT FOR USE with gate leaves weighing over 240 lbs.

** Available in BLACK only*

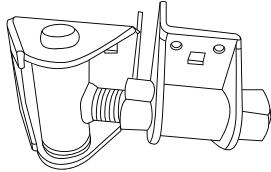

Commercial / Industrial Adjustable 180° Hinge	.625" - 2.5"	MHH180*	1 pr	7 lbs
--	--------------	---------	------	-------

For use with: Montage Plus Gates | Montage II Gates | Aegis Plus Gates | Aegis II Gates | Echelon Plus Gates | Echelon II Gates | Estate Gates

NOT FOR USE with gate leaves weighing over 420 lbs.

** Available in BLACK only*

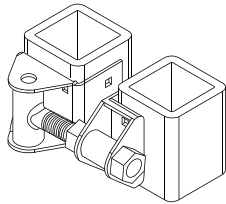

Heavy Industrial / Security Adjustable 180° Hinge	.625" - 2.5"	MIH180*	1 pr	20 lbs
--	--------------	---------	------	--------

For use with: Montage II Gates | Aegis II Gates | Echelon II Gates | Impasse II Gates

Notes: Recommended for gate leaves over 60" sq. area (height x OTO) and when 6" sq. posts are required.

NOT FOR USE with gate leaves weighing over 3,000 lbs.

** Available in BLACK only*

Effective: 01/06/15

ORNAMENTAL GATE HARDWARE | GATE LATCHES & DROP ROD

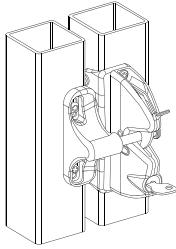

DESCRIPTION	HINGE CLEARANCE	ITEM NUMBER	BOX QTY	BOX WEIGHT
Residential LokkLatch	.75"	LLAAB*	1	1 lbs

For use with: Montage Gates | Montage Arched Gates | Echelon Gates | Echelon Arched Gates

Notes: Key lockable | Adjusts horizontally & vertically | Push-Button External Access Kit

** Available in BLACK only*

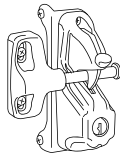

Heavy Duty LokkLatch Deluxe	.75"	LLDAB-KSA*	1	1.32 lbs
------------------------------------	------	------------	---	----------

For use with: Montage Gates | Montage Arched Gates | Echelon Gates | Echelon Arched Gates

Notes: Operates & locks from both sides of the gate | Dual 6-pin re-keyable lock | Fully adjustable

** Available in BLACK only*



Top Pull Magna Latch	.75"	ML3TPKA*	1	1.43 lbs
-----------------------------	------	----------	---	----------

For use with: Montage Gates | Montage Arched Gates | Echelon Gates | Echelon Arched Gates

Notes: Magnetically triggered latching | Key lockable safety | Adjusts horizontally & vertically | Quick & easy to install | Patented "Lost Motion" Technology

** Available in BLACK only*

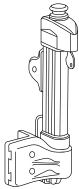

Vertical Pull Magna Latch	.75"	ML3VPKA*	1	1 lbs
----------------------------------	------	----------	---	-------

For use with: Montage Gates | Montage Arched Gates | Echelon Gates | Echelon Arched Gates

Notes: Magnetically triggered latching | Key lockable safety | Adjusts horizontally & vertically | Quick & easy to install | Patented "Lost Motion" Technology

** Available in BLACK only*

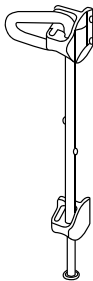

24" Q-Bolt Drop Rod	n/a	QB124*	1	2.6 lbs
----------------------------	-----	--------	---	---------

For use with: Montage Gates | Montage Arched Gates | Echelon Gates | Echelon Arched Gates

Notes: Padlockable security | Fits 1" or larger gate frames | Ergonomic handle

** Available in BLACK only*

ORNAMENTAL GATE HARDWARE | GATE LATCHES

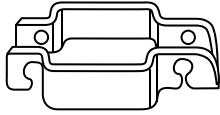

DESCRIPTION	LENGTH	LATCH CLEARANCE	ITEM NUMBER	BOX QTY	WEIGHT EA.
Latch Hanger	1.25"	2"	H⊗301*	100	.50 lbs
	1.75"	2"	H⊗311**	100	.60 lbs
	2"	2"	H⊗420***	100	.65 lbs

*For use with: Montage Gates | Aegis Gates | Echelon Gates | Echelon Arched Gates

**For use with: Montage Plus Gates | Aegis Plus Gates | Echelon Plus Gates

***For use with: Aegis Plus Gates | Aegis Plus Arched Gates | Echelon Plus Gates | Estate Gates

Notes: Supplied with stainless steel fasteners | Pressed steel hanger

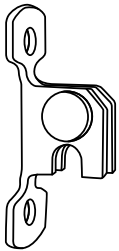

Wall Mount Plate Latch	n/a	2"	H⊗305	100	.30 lbs
------------------------	-----	----	-------	-----	---------

For use with: Montage Gates | Aegis Gates | Echelon Gates | Echelon Arched Gates

Notes: Pressed steel plate | Mounting fasteners NOT INCLUDED | Bolt & nut INCLUDED for fork latch | Screw or anchor to wall or other flat surfaces

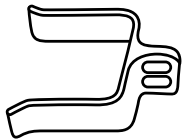

Fork Latch	1.25"	2"	H⊗401*	100	.34 lbs
	1.75"	2"	H⊗410**	50	.38 lbs
	2"	2"	H⊗402***	100	.42 lbs
	2.5"	2"	H⊗411†	50	.44 lbs
	3"	2"	H⊗412†	50	.46 lbs

*For use with: Montage Gates | Aegis Gates | Echelon Gates

**For use with: Montage Plus Gates | Aegis Plus Gates | Echelon Plus Gates

***For use with: Montage Gates | Aegis Gates | Echelon Gates | Estate Gates | ALL ARCHED GATES

†For use with: ALL GATES

Notes: Pressed steel fork | Mounting fasteners NOT INCLUDED

⊗ = COLOR OPTIONS AVAILABLE | B = Black | N = Bronze | S = Sand | W = White

Effective: 01/06/15

ORNAMENTAL GATE HARDWARE | GATE LATCHES

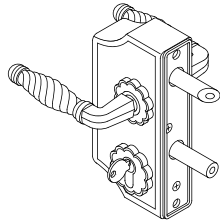

DESCRIPTION	SIZE	LATCH CLEARANCE	ITEM NUMBER	BOX QTY	BOX WEIGHT
Ameristar Lock	1" x 1.25"	.625"	HB504S*†	1	4 lbs
	1.5" x 2"	.625"	HB509S**†	1	4 lbs

*For use with: Montage Gates | Aegis Gates | Echelon Gates

**For use with: ALL GATES

Notes: Security lock with keyed cylinder | Stainless steel striker plates for lock INCLUDED | Allow .5" to .625" between gate end & post when installing

† Available in BLACK only

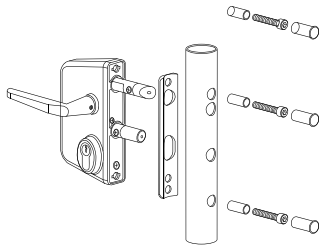

Chain Link Lock	1.375" x 1.875"	n/a	HA504S*	1	4 lbs
-----------------	-----------------	-----	---------	---	-------

For use with: GalvOnAll Gates

Notes: Security lock with keyed cylinder | Stainless steel striker plates for lock INCLUDED | Allow .5" to .625" between gate end & post when installing

*Uncoated for round pipe frames

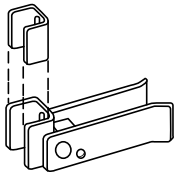

Strong Arm Single Gate Latch	2.5"	3" / 5" gap	DS@250	1	4 lbs
	3"	3" / 5" gap	DS@300	1	4 lbs
	4"	3" / 5" gap	DS@100	1	4 lbs
	6"	3" / 5" gap	DS@600	1	7 lbs

For use with: Montage Plus Gates | Montage II Gates | Aegis Plus Gates | Aegis II Gates | Echelon Plus Gates | Echelon II Gates | Estate Gates

Notes: Fits 1.75" or 2" sq. frame

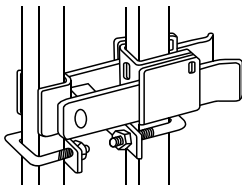

Strong Arm Double Gate Latch	2.5" / 3.25" gap	3"	DS@200	1	6 lbs
------------------------------	------------------	----	--------	---	-------

For use with: Montage Plus Gates | Montage II Gates | Aegis Plus Gates | Aegis II Gates | Echelon Plus Gates | Echelon II Gates | Estate Gates

Notes: Fits 1.75" or 2" sq. frame

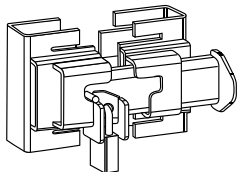

Industrial Double Drive Gate Latch	2"	3.5"	DDB200†	1	7.5 lbs
------------------------------------	----	------	---------	---	---------

For use with: Impasse II Gates

Notes: Heavy duty galvanized steel double drive gate latch.

† Available in BLACK only

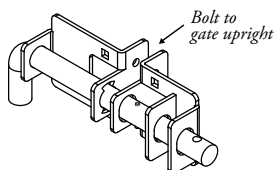

Heavy Duty Slide Latch	up to 1" gap	1"	SLB100†	1	6.6 lbs
------------------------	--------------	----	---------	---	---------

For use with: Montage II Gates | Aegis II Gates | Echelon II Gates | Impasse II Gates

Notes: Heavy duty galvanized steel slide latch with 1" diameter bar.

† Available in BLACK only

Effective: 01/06/15

ORNAMENTAL GATE HARDWARE | DROP BOLTS & RODS

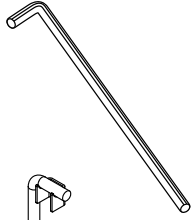

DESCRIPTION	LENGTH	ITEM NUMBER	BOX QTY	WEIGHT EA.
Cane Bolt	48"	Hⓧ316	1	5 lbs

For use with: ALL GATES

Notes: .625" diameter steel cane bolt | Heavy-duty to keep gate leaf rigidly in place

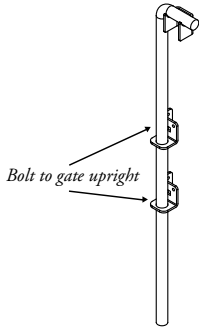

Drop Rod	34"	DLB100*	1	12 lbs
----------	-----	---------	---	--------

For use with: ALL GATES

Notes: 1" diameter steel cane bolt | Heavy-duty to keep gate leaf rigidly in place

*Available in BLACK only

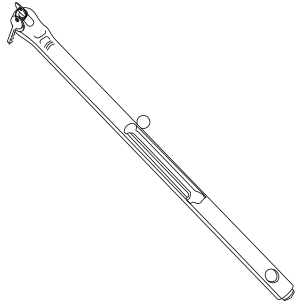

Surface Mounted Drop Bolt	adjustable	KDQFBL	1	13.5 lbs
---------------------------	------------	--------	---	----------

For use with: ALL DOUBLE SWING GATES

Notes: Lockable drop bolt with cylinder | Adjustable height in x3 positions (2" per position) | Gate can be opened or closed in any position | For gate profiles 1.5" x 1.5" or greater

*Available in BLACK only

ⓧ = COLOR OPTIONS AVAILABLE | **B** = Black **N** = Bronze **S** = Sand **W** = White

Effective: 01/06/15

ORNAMENTAL GATE HARDWARE | GATE ACCESSORIES

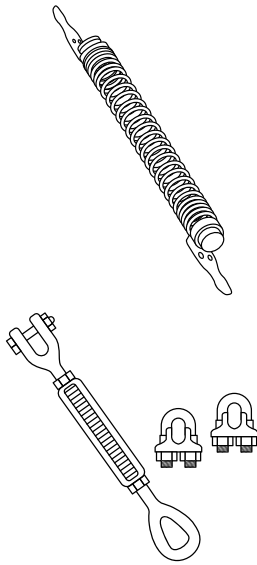

DESCRIPTION	LENGTH	ITEM NUMBER	BOX QTY	WEIGHT EA.
Gate Spring	13"	H⊗701	30	1.3 lbs

For use with: Montage Gates | Aegis Gates | Echelon Gates | Echelon Arched Gates

Notes: Adjustable tension spring for self-closing applications | Heavy-duty ideal for ornamental steel swing gates | (4) #10 x .5" self-drilling screws INCLUDED

Truss Cable Kit for Ornamental Gates	n/a	MTK100	1	15 lbs
--------------------------------------	-----	--------	---	--------

For use with: ALL GATES

Notes: Mounts on all swing gates with gusset plates in corners

*Kit includes: (1) ea .3125" - 18 x 4.5" Jaw & Eye Turnbuckle
(2) ea .1875" Cable Clamps
(12') .1875" Black PVC Coated Steel*

**Available in BLACK only*

⊗ = COLOR OPTIONS AVAILABLE | **B** = Black **N** = Bronze **S** = Sand **W** = White

SURECLOSE® GATE HARDWARE | STEEL HINGES

EXTERNAL MOUNT | .5"- 1.375" HINGE GAP | 180° MAX SWING | HORIZONTALLY & VERTICALLY ADJUSTABLE | SOLD INDIVIDUALLY

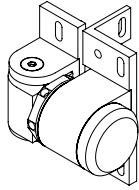

HINGE / SM

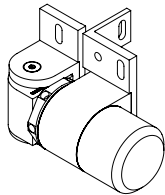

CLOSER / 108

DESCRIPTION	SELF-CLOSING	FINAL SNAP ACTION	ITEM NUMBER	POOL / CHILD SAFETY
RF <u>SMW</u> – ReadyFit Hinge	⊘	⊘	74001315	⊘
RF <u>108W</u> – ReadyFit Closer	from 85°	✓	74108315	⊘
RF <u>108SF W</u> – ReadyFit Closer	from 90°	✓	74108325*	✓

Notes: Gate mounting brackets & fasteners INCLUDED with hinge/closers | SF gates WILL NOT hold open at 90° (excluding SAFETY GATES) | DO NOT use a hinge with a 90° hold open feature for POOL GATES | Gate Stop must be installed when using SF models – gate MUST NOT be allowed to open past 90° – doing so VOIDS WARRANTY

SURECLOSE® GATE HARDWARE | ALUMINUM HINGES

EXTERNAL MOUNT | .5"- 1.375" HINGE GAP | 180° MAX SWING | HORIZONTALLY & VERTICALLY ADJUSTABLE | SOLD INDIVIDUALLY

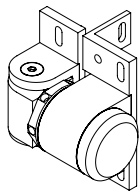

HINGE / SM

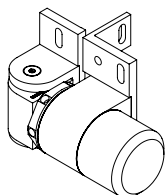

CLOSER / 108

DESCRIPTION	SELF-CLOSING	FINAL SNAP ACTION	ITEM NUMBER	POOL / CHILD SAFETY
RF <u>SMS</u> – ReadyFit Hinge	⊘	⊘	74001313	⊘
RF <u>108S</u> – ReadyFit Closer	from 85°	✓	74108313	⊘
RF <u>108SF S</u> – ReadyFit Closer	from 90°	✓	74108323*	✓

Notes: Gate mounting brackets & fasteners INCLUDED with hinge/closers | SF gates WILL NOT hold open at 90° (excluding SAFETY GATES) | DO NOT use a hinge with a 90° hold open feature for POOL GATES | Gate Stop must be installed when using SF models – gate MUST NOT be allowed to open past 90° – doing so VOIDS WARRANTY

Effective: 01/06/15

SURECLOSE® GATE HARDWARE | ALUMINUM CENTER MOUNT HINGES

SCREW-ON | 90° MAX GATE SWING | 2.5"-3" HINGE GAP | HORIZONTALLY ADJUSTABLE

SURECLOSE® HINGE COMBINATIONS QUICK REFERENCE GUIDE

HINGE COMBINATIONS	SELF-CLOSING GATE MAX WEIGHT	POINT LOAD CAPACITIES
<u>108</u> + <u>SM</u>	180 lbs* / 80 kgs*	1,500 lbs / 680 kgs
<u>108</u> + <u>108</u>	260 lbs* / 120 kgs*	1,500 lbs / 680 kgs
<u>SM</u> + <u>SM</u>	n/a	1,500 lbs / 680 kgs

* BASED ON MAX GATE SIZE / 72" h x 40" w (1,800 mm x 1,000 mm)

SM = Non-Self Closing Hinge | 108 = Self-Closing Hinge / 85° - 90° (holds gate open at 90°)



SURECLOSE® POOL LATCH & BRACKET SAFETY WARNING

FIFTH DIMPLE

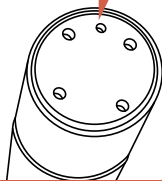

Pool & child safety gate latch hardware (SF) can be identified visually very easily by locating the "fifth dimple" on the end cap.

DO NOT USE ANY NON-SF MODELS (with only four dimples) ON GATES WHERE HUMAN SAFETY COULD BE AT RISK!

Effective: 01/06/15